

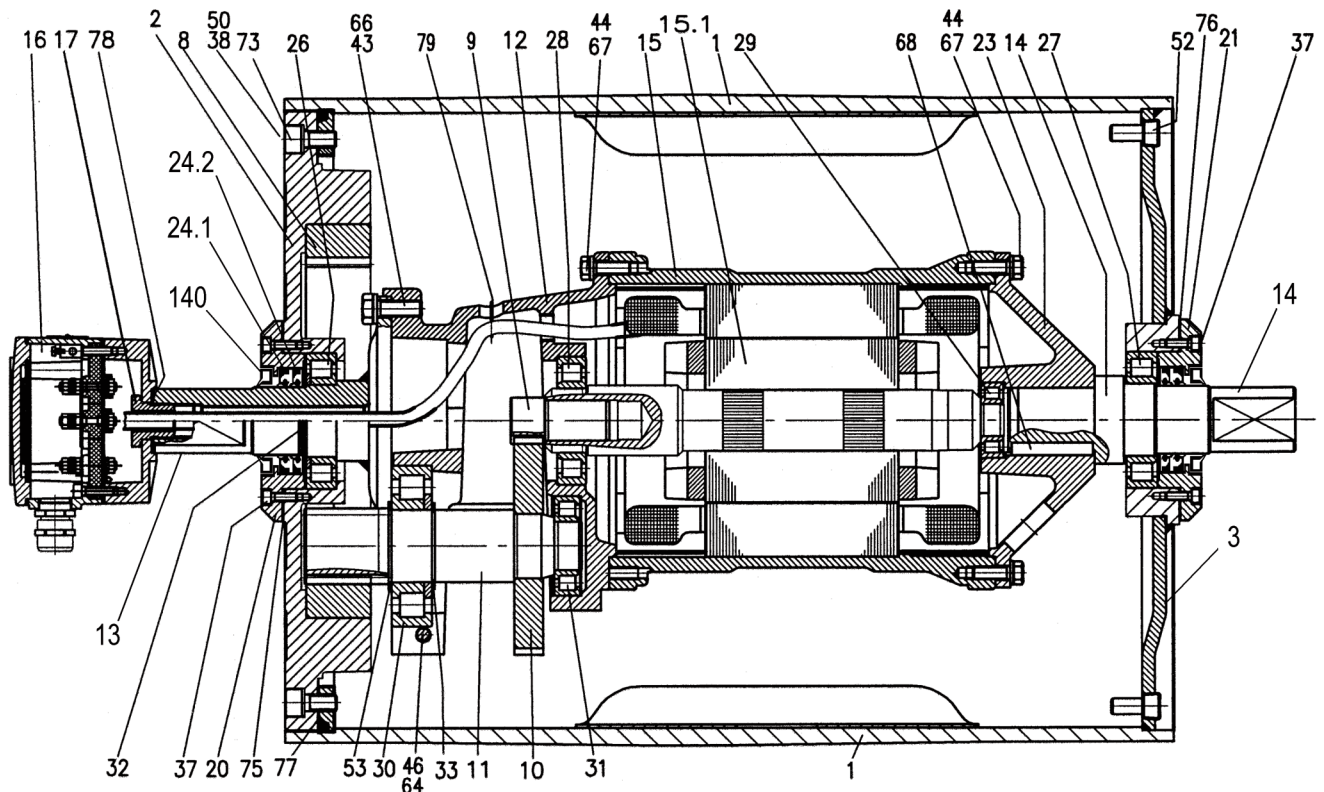

# Motorized Pulley 400L, Ø 15.91 in. (404 mm)

## Spare parts list and sectional drawings

Pos.	Description	Pos.	Description	Pos.	Description
1	Shell	24.3	Shaft oil seal outer (lab option)	68	Key
1.1	Shell (ss option)	24.4	Shaft oil seal inner (lab option)	73	Set screw
2	End housing with geared rim	26	Bearing	75	Gasket
2.1	End housing (ss option)	27	Bearing	76	Gasket
3	End housing	28	Bearing	77	Gasket
3.1	End housing (ss option)	29	Bearing	78	Gasket
8	Geared rim	30	Bearing	79	Holding clip or plastic tie
9	Rotor pinion	31	Bearing	85	Intermediate flange for backstop
10	Input wheel	32	Retaining ring	85.1	Intermediate flange for brake
11	Output pinion	33	Retaining ring	90	Backstop
12	Gear box — cast aluminum	37	Hexagon socket screw	91	Electromagnetic brake
13	Front shaft	38	Hexagon socket screw	93	Retaining ring
13.1	Front shaft (ss option)	43	Hexagon screw	94	Hexagon head screw
14	Rear shaft	44	Hexagon screw	95	Straight connector
14.1	Rear shaft (ss option)	45	Hexagon socketed head screw	96	Elbow connector
15	Stator complete	46	Hexagon screw	99	Waved spring washer
15.1	Rotor	49	Washer	101	Key
16	Terminal box complete	50	Washer	104	Distance washer
17	Nipple	52	Magnetic oil plug	120	Labyrinth cover
20	Cover — front side	52.1	Magnetic plug (ss option)	121	Set screw
20.1	Cover with labyrinth groove	53	Distance washer	122	O-ring
21	Cover — rear side	53.1	Compression nipple	123	Grease nipple
21.1	Cover with labyrinth groove	60	Parallel pin	140	Deflection seal
23	Rear flange	64	Prevailing torque type hex nut	143	O-ring
24.1	Shaft oil seal outer	66	Waved spring washer	146	Special compression washer
24.2	Shaft oil seal inner	67	Waved spring washer	200	Rubber seal





# Motorized Pulley 400M, Ø 15.91 in. (404 mm)

## Spare parts list and sectional drawings

Pos.	Description	Pos.	Description	Pos.	Description
1	Shell	23	Rear flange	66	Waved spring washer
1.1	Shell (ss option)	24.1	Shaft oil seal outer	67	Waved spring washer
2	End housing with geared rim	24.2	Shaft oil seal inner	70	Spring washer
2.1	End housing (ss option)	24.3	Shaft oil seal outer (lab option)	73	Set screw
3	End housing	24.4	Shaft oil seal inner (lab option)	75	Gasket
3.1	End housing (ss option)	26	Bearing	76	Gasket
8	Geared rim	27	Bearing	77	Gasket
9	Rotor pinion	28	Bearing	78	Gasket
10	Input wheel	29	Bearing	85	Intermediate flange
11	Output pinion	30	Bearing	90	Backstop
12	Gear box — cast aluminum	31	Bearing	91	Electromagnetic brake
13	Front shaft	32	Retaining ring	93	Retaining ring
13.1	Front shaft (ss option)	36	Hexagon head screw	94	Hexagon head screw
14	Rear shaft	45	Hexagon screw	99	Waved spring washer
14.1	Rear shaft (ss option)	50	Waved spring washer	101	Key
15	Stator complete	52	Magnetic oil plug	104	Distance washer
15.1	Rotor	52.1	Magnetic oil plug (ss option)	120	Labyrinth cover
16	Terminal box complete	37	Hexagon socket screw	121	Set screw
17	Nipple	38	Hexagon socket screw	122	O-ring
20	Cover — front side	43	Hexagon screw	123	Grease nipple
20.1	Cover with labyrinth groove	44	Hexagon screw	140	Deflection seal
21	Cover — rear side	52	Magnetic oil plug		
21.1	Cover with labyrinth groove	53	Distance washer		

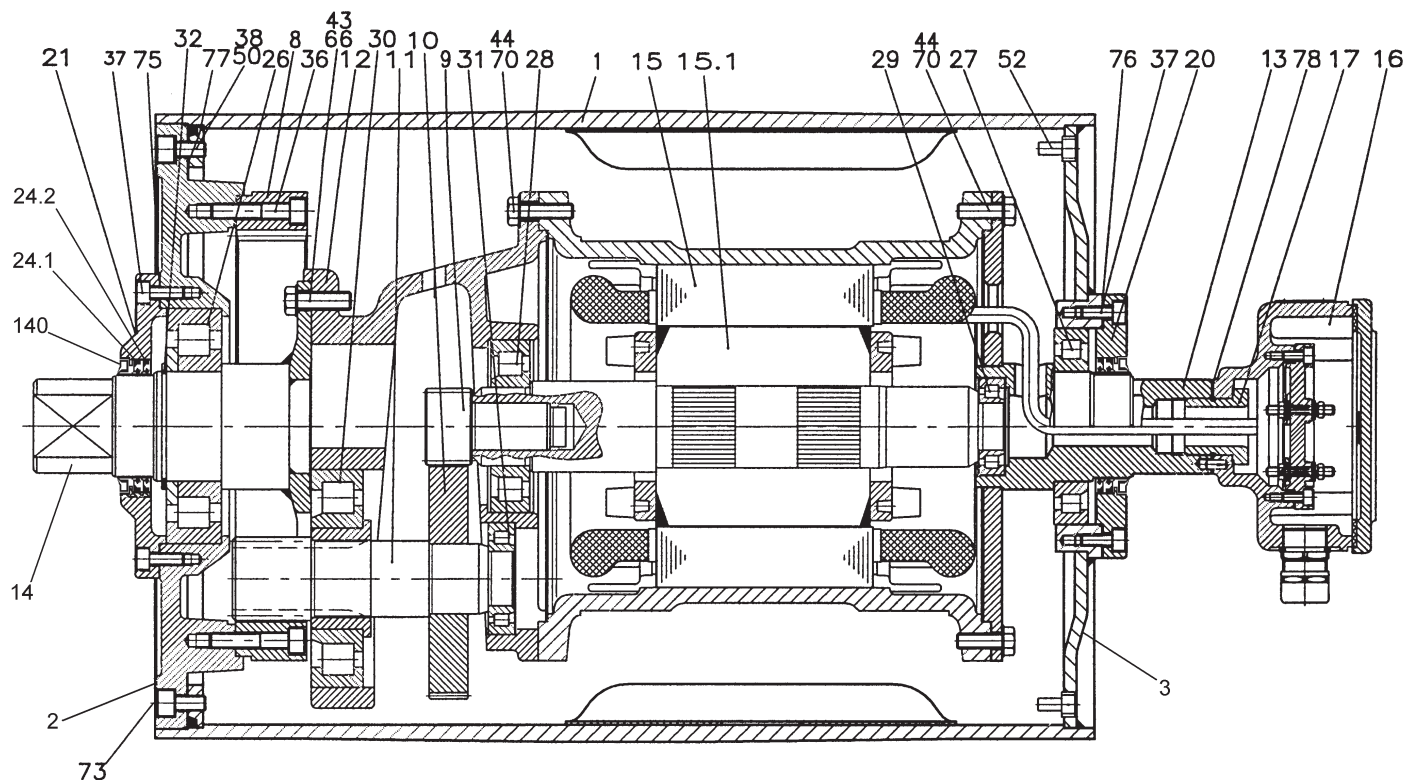



# Motorized Pulley 400H, Ø 15.91 in. (404 mm)

## Spare parts list and sectional drawings

Pos.	Description	Pos.	Description	Pos.	Description
1	Shell	28	Bearing	76	Gasket
1.1	Shell (ss option)	30	Bearing	77	Gasket
2	End housing with geared rim	31	Bearing	78	Gasket
2.1	End housing (ss option)	32	Retaining ring	85	Intermediate flange for brake
3	End housing	33	Retaining ring	90	Backstop
3.1	End housing (ss option)	36	Hexagon socket screw	91	Electromagnetic brake
8	Geared rim	37	Hexagon socket screw	93	Retaining ring
9	Rotor pinion	38	Hexagon socket screw	94	Hexagon head screw
10	Input wheel	43	Hexagon socket screw	99	Waved spring washer
11	Output pinion	44	Hexagon socket screw	101	Key
12	Gear box — cast iron	45	Hexagon socket screw	104	Distance washer
13	Front shaft	50	Waved spring washer	120	Labyrinth cover
13.1	Front shaft (ss option)	52	Magnetic oil plug	121	Set screw
14	Rear shaft	52.1	Magnetic oil plug (ss option)	122	O-ring
14.1	Rear shaft (ss option)	53	Distance washer	123	Grease nipple
15	Stator complete	66	Waved spring washer	140	Deflection seal
15.1	Rotor	72	Taper grooved pin	180	Intermediate pinion shaft
16	Terminal box complete	73	Set screw	181	Intermediate wheel
17	Nipple	75	Gasket	182	Distance washer
20	Cover Front side			183	Distance washer
20.1	Cover with labyrinth groove			184	Roller bearing
21	Cover rear side			185	Roller bearing
21.1	Cover with labyrinth groove			186	Key
23	Rear flange			187	Key
24.1	Shaft oil seal outer			188	Retaining ring
24.2	Shaft oil seal inner			190	Retaining ring
24.3	Shaft oil seal outer (lab option)			191	Retaining ring
24.4	Shaft oil seal inner (lab option)			194	Set screw
26	Bearing			196	Key
27	Bearing			197	Retaining ring

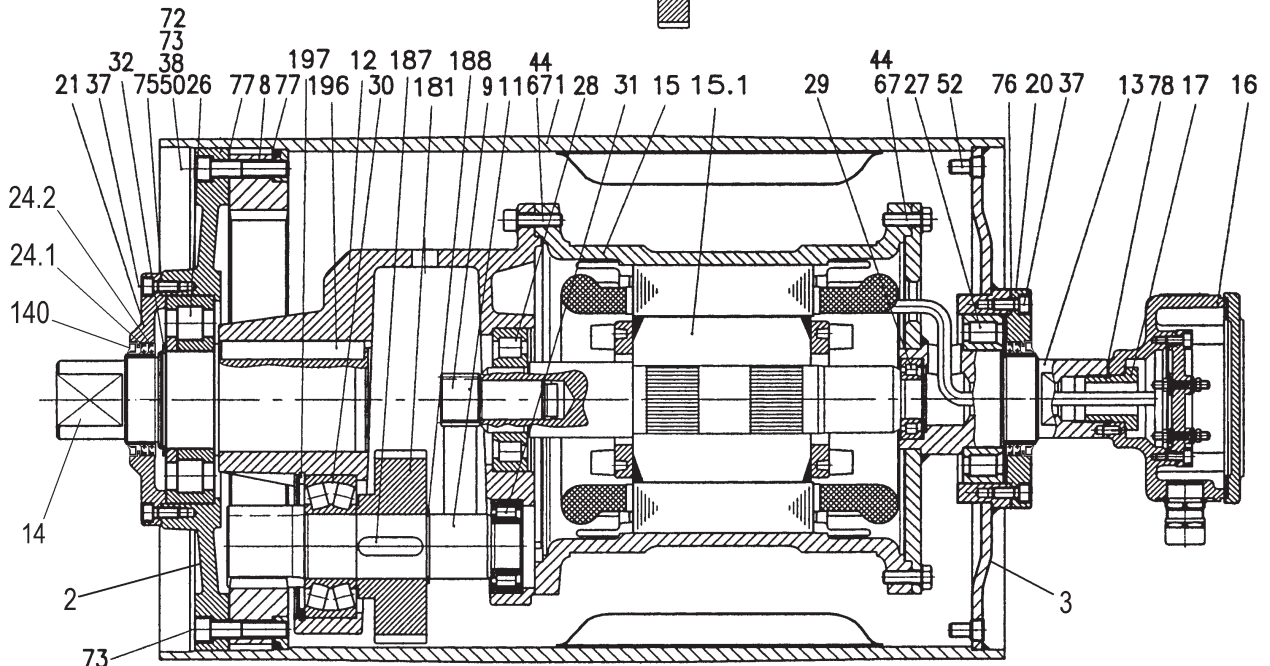
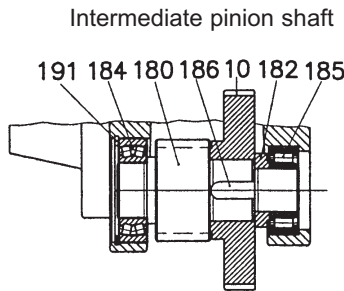



# Motorized Pulley 400L, 400M & 400H, Ø 15.91 in. (404 mm) Sectional drawings

Backstop Option (valid for 400M & 400H)

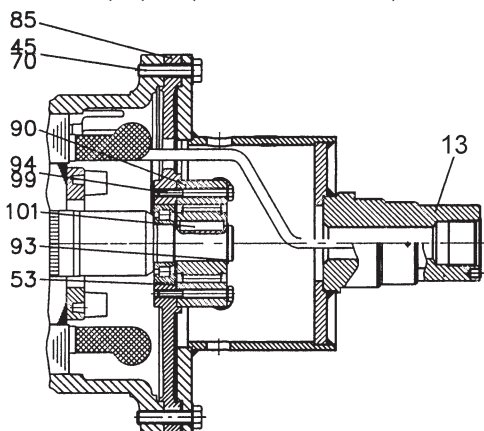

Electromagnetic Brake Option (valid for 400M & 400H)

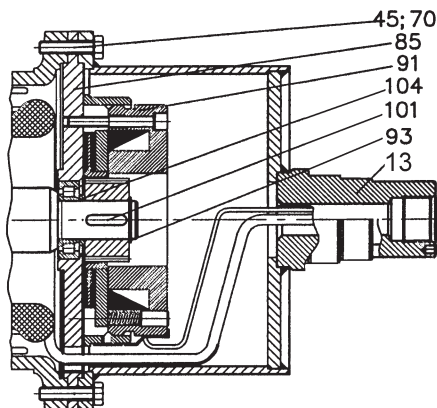

Backstop Option (valid for 400L)

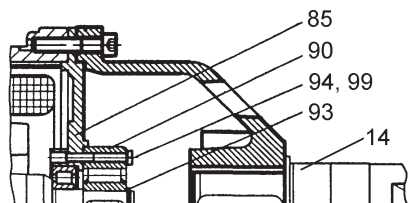

Stainless Steel with Labyrinth Options TS9N  
(Position 1 for carbon steel shell valid for TS11N only)

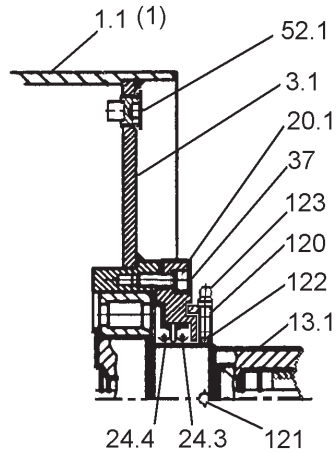
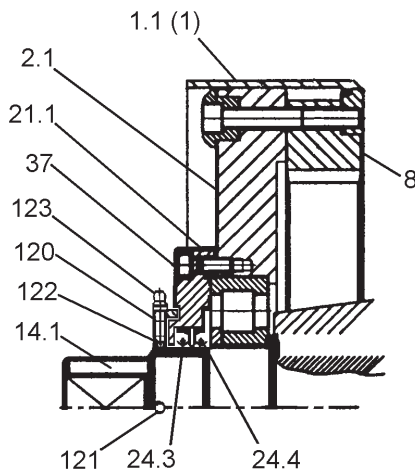

Electromagnetic Brake Option (valid for 400L)

Stainless Steel Non-Labyrinth Options TS10N  
(Position 1 for carbon steel shell valid for TS12N only)

