



# Motorized Pulley 165LS

Ø 6.50 in. (165 mm), helical steel gearbox

## Spare Parts List and Sectional Drawings

1	Front shaft	53	Terminal box nipple	103	Screw
3	Rear flange	53.1	Cable seal nipple	110	Screw
5	Bearing housing complete with geared rim	55	Spacer bushing	111	Screw
7	Bearing housing complete	56	Spacer bushing	112	Socket set screw
8	Gearbox	63	Ball bearing	113	Screw
10	Terminal box - bottom part	64	Needle bearing	115	Oil plug with magnet
11	Terminal box cover	65-70	Ball bearing	126	Key
12	Shell	71	Inner race	127	Key
16	Rear shaft	73	Locking ring	131	Key
19	Input wheel	74	Locking ring	132	Key
20	Output pinion	81	Locking ring	136	O-ring/Rubber seal
22	Geared rim	84	Locking ring	138	Rubber seal
23	Intermediate pinion shaft	85	Locking ring	140	Deflection seal
24	Intermediate wheel	86	Locking ring	141	Double lip seal
31	Labyrinth seal cover	93	Elbow or straight connector	142	Double lip seal
		102	Screw	145	Distance washer

## 165LS Standard: 2 stage gearbox with terminal box

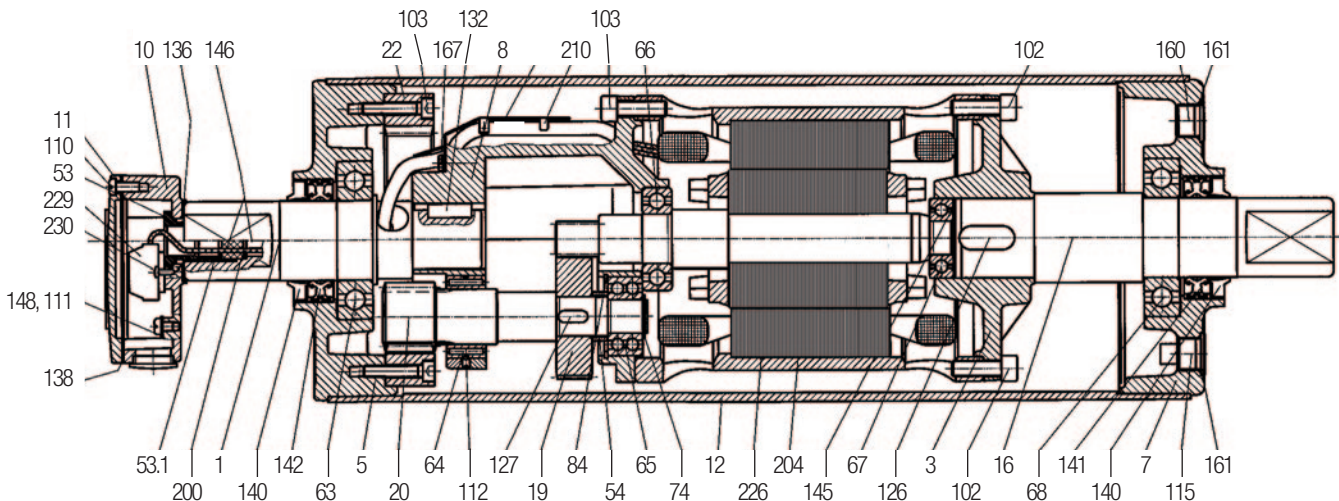

# Motorized Pulley 165LS

Ø 6.50 in. (165 mm), helical steel gearbox



## Spare Parts List and Sectional Drawings (cont.)

146	Washer	209	Stainless steel cover - oil plug end	229	Terminal block
148	Washer	210	Fixing guard	230	Screw
150	Electromagnetic brake	223	Cable	240	Distance ring
150.1	Friction disc	226	Stator complete		
156	Rectifier (not shown)				
160	Oil plug				
161	O-ring				
163	O-ring				
167	Screw				
200	Rubber seal				
204	Rotor complete with pinion				
206	Insulated sleeve for wire protection				
208	Stainless steel cover - gear end				

**Standard straight cable connection**

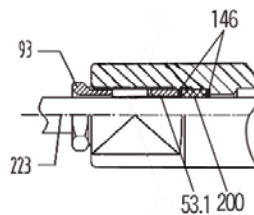

**Standard elbow cable connection**

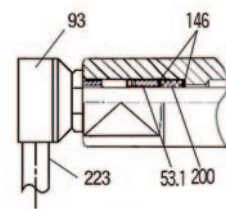

**Stainless steel option oil plug**

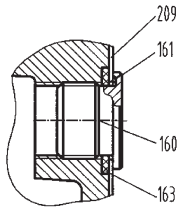

**Stainless steel option with straight cable connection**

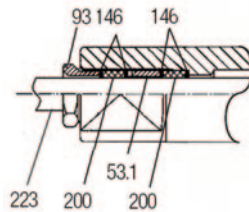

**Stainless steel option with elbow cable connection**

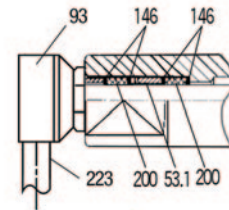

**Stainless steel end housing**

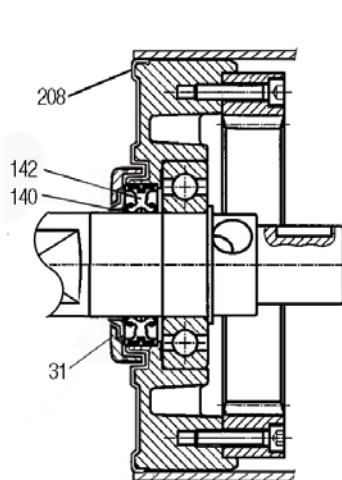

**3-stage gearbox**

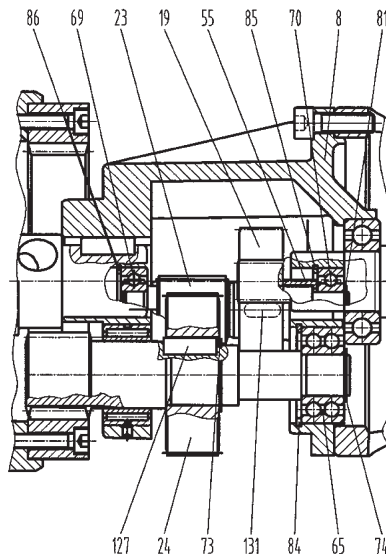

**Electromagnetic brake**

